

Diffusers

for walls, ceiling, & floors

Series GSL Linear Slot Diffuser



Description

Linear Slot Diffuser has been designed to meet the exacting performance requirements and standards of modern slot diffuser applications. Combining up to date styling and design technology to blend with modern architecture the GSL maintains excellent air distribution characteristics providing smooth, accurate and flexible airflow control making the unit suitable for both fan coil, VAV and conventional Linear Slot applications.

Construction

From extruded aluminium sections, with cylindrical, black or white plastic nozzles.

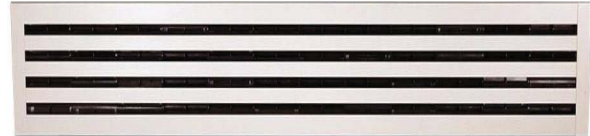

Size

Height of slot diffuser is determined by the number of slots, usually to a maximum of 8 slots. The slot diffuser is designed to form long continuous lengths but is also effective in short sections.

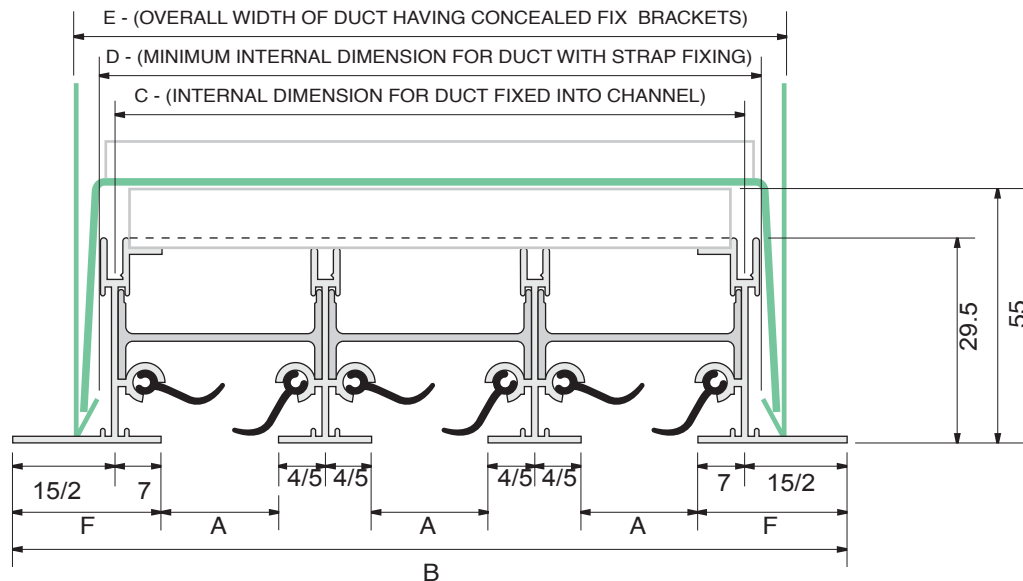

Slot 20

No. of Slots	A	B	C	D	E	F
1	20	70	34	48	56	22
2	20	110	74	88	96	22
3	20	150	114	128	136	22
4	20	190	154	168	176	22
5	20	230	194	208	216	22
6	20	270	134	248	256	22
7	20	310	174	288	296	22
8	20	350	314	328	336	22

Slot 25

No. of Slots	A	B	C	D	E	F
1	25	75	39	53	61	25
2	25	120	84	98	106	25
3	25	165	129	143	151	25
4	25	210	174	188	196	25
5	25	255	219	233	241	25
6	25	300	264	278	268	25
7	25	345	309	323	301	25
8	25	390	354	368	376	25

Series DG Multi-Cone Ceiling Diffuser



Description

For supply or extract air. Multi-cone design with quick release core and 2 position setting for heating and cooling. Flanged for surface mounting or lay-in ceiling grid.

Construction

For extruded aluminium cores offering the benefit of hair line mitre joints. Optional OBD is extruded aluminium.

Size

Neck size are available 150mm x 150mm to 450mm x 450mm.

How to Specify

State Quantity, the series, product coding and the size width x height
e.g **10 Qty. DGA4W0OBD+1X 450 x 450**



Series	Frame Style	Core	Options	Accessories	+	Fixings	Finish						
DG	A	Aluminium	4A	4 - Way		0	None	0	None	1	Neck Fixings	X	PPC /RAL 9010 White
			3A	Blanked to 3 - Way		T	Top Inlet Plenum	OBD	Opposed Blade Damper	2	Lay-in Tile Replacer	Y	PPC BS/Ral Colour
			2A	Blanked to 2 - way		S	Side Inlet Plenum	TBD	Twin Blade Damper				
			1A	Blanked to 1 - way									

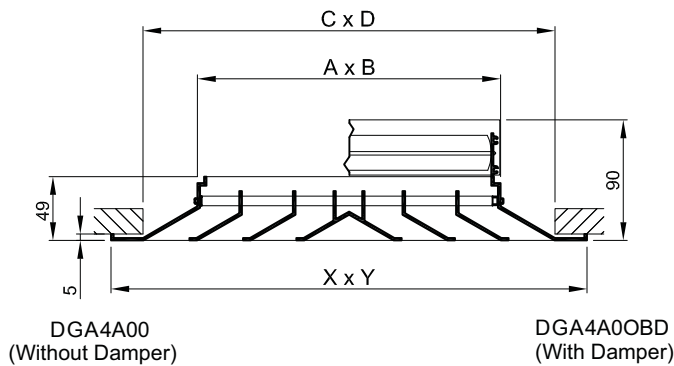

A x B	C x D	X x Y
150 x 150	250 x 250	290 x 290
225 x 225	325 x 325	365 x 365
300 x 300	400 x 400	440 x 440
450 x 450	550 x 550	595 x 595

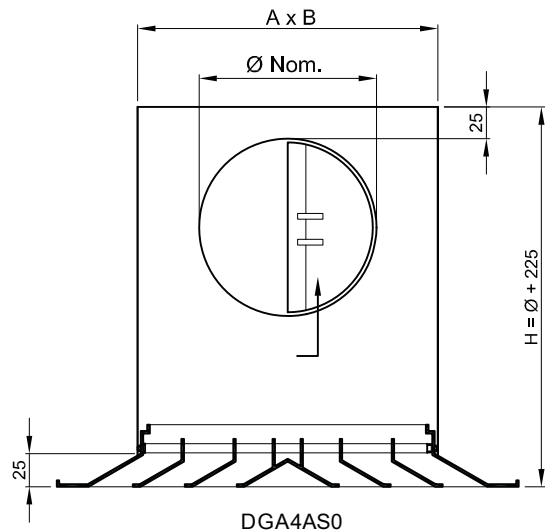
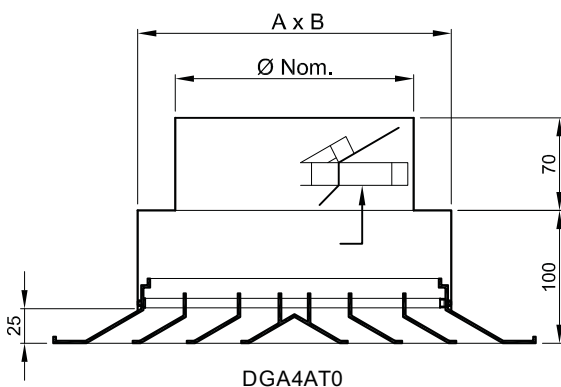

Series D Multi-Cone Ceiling Diffuser Set Into Lay-in Ceiling Panel



Description

For supply or extract air, multi-cone design with quick release core and 2 position setting for heating and cooling. Available in a range of different core styles and sizes giving total flexibility for installation in lay in ceiling tile applications.

Construction

For extruded aluminium sections, set into a zintec steel panel, outer frame and inner cores 1.6mm thick. Hairline mitres mechanically held. Optional OBD is extruded aluminium.

Size

Sizes to suit 600mm x 600mm ceiling grid arrangements.

How to Specify

State Quantity, the series, product coding and the size width x height
e.g Qty. DG4BSOBD+2X 595 x 595 10



Series	Frame Style		Core	Options		Accessories		+	Fixing		Finish	
	L	Lay-in Ceiling Tile							1	Lay-in Tile Replacer	X	PPC /RAL 9010 White
DG			4B	4 - Way	0	None	0	None			Z	Mill Finish
			3B	3 - Way	T	Top Inlet Plenum	OBD	Opposed Blade Damper				
			2B	2 - way	S	Side Inlet Plenum	TBD	Twin Blade Damper				
			1B	1 - way								

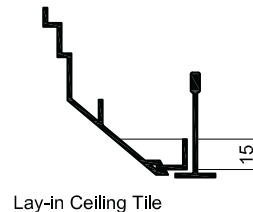
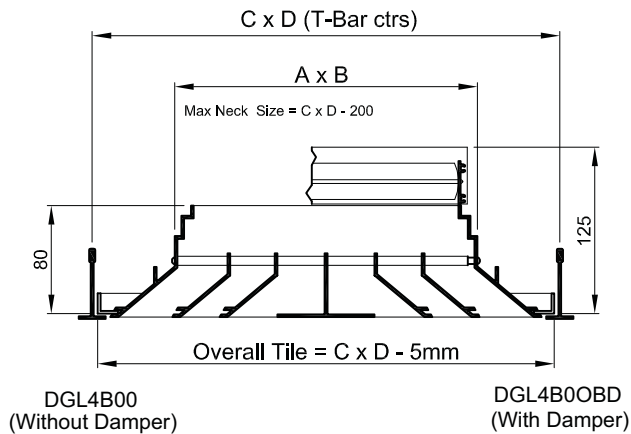

Multi-Cone Ceiling Diffusers Core Options



Core

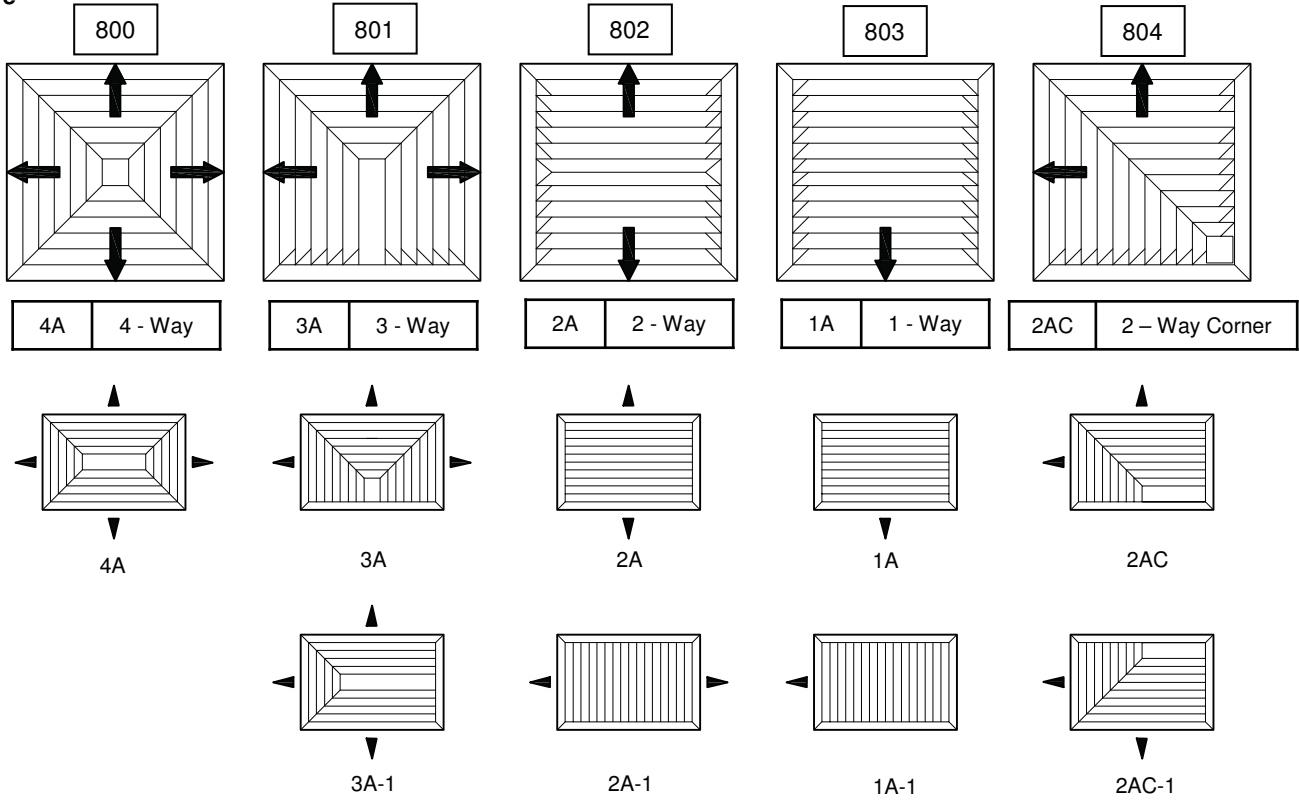

All throw patterns as viewed on rear of diffuser neck.

4 - Way Multi Cone Diffusers with factory fitted directional blanking plate

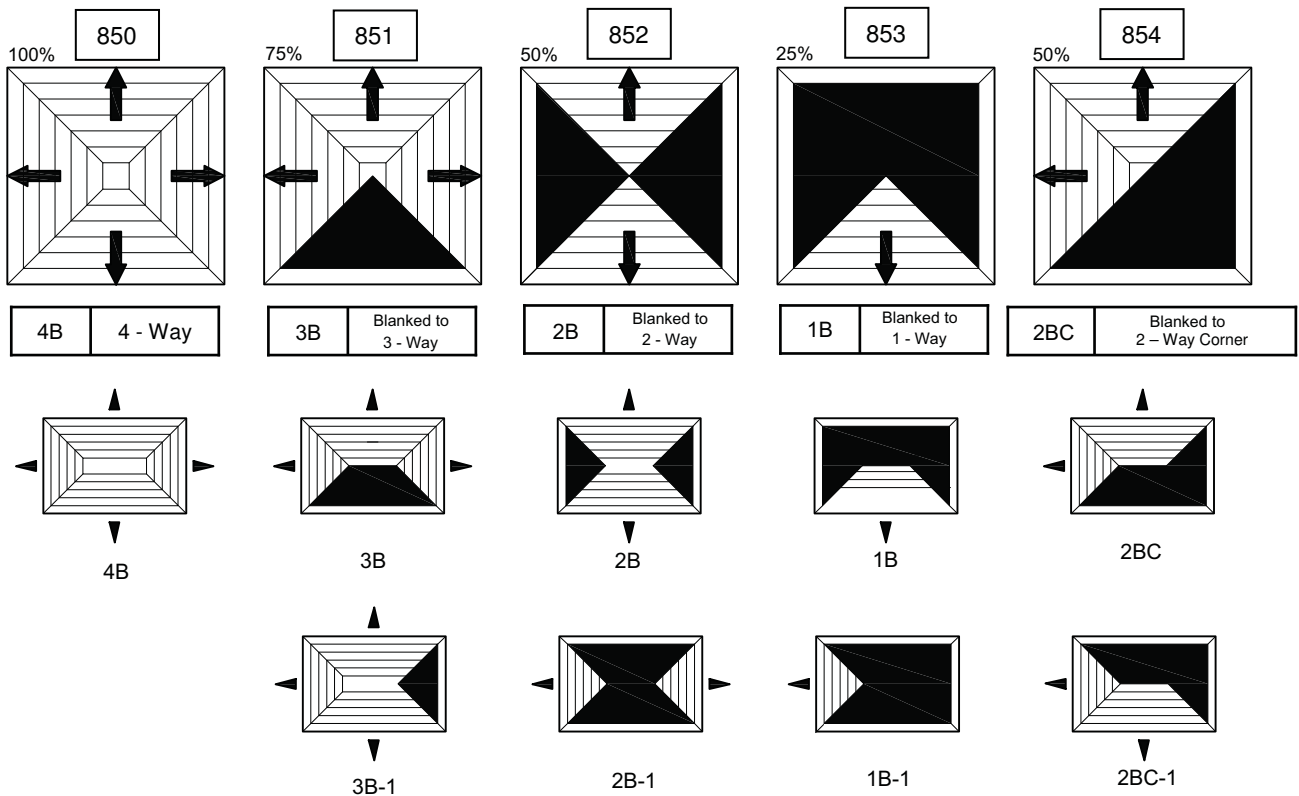

All throw patterns as viewed on rear of diffuser neck.

Copy right © - All rights reserved by IGC

Series DG Technical Data Multi-Cone Diffusers

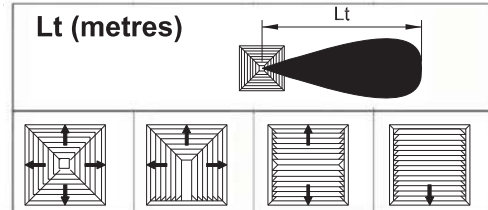
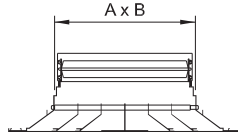

q (l/s)	A x B	Vn (M/s)	Ps (Pascals)	NC	4A (4 - Way)	3A (3 - Way)	2A (2 - Way)	1A (1 - Way)
40	150 x 150	1.8	7	-	0.9 - 1.8	1.0 - 2.0	1.2 - 2.2	1.4 - 2.4
	200 x 200	1.0	4	-	0.6 - 1.2	0.7 - 1.5	0.9 - 2.0	1.2 - 2.6
60	150 x 150	2.7	16	-	1.5 - 2.4	1.6 - 2.6	1.8 - 3.0	2.2 - 3.5
	200 x 200	1.5	7	-	1.0 - 1.7	1.0 - 2.0	1.3 - 2.5	1.6 - 3.0
80	150 x 150	3.6	30	23	1.8 - 3.6	2.1 - 4.0	2.4 - 4.4	3.0 - 5.5
	200 x 200	2.0	14	20	1.5 - 2.3	1.7 - 2.8	2.0 - 3.2	2.6 - 3.8
	250 x 250	1.3	2	-	0.6 - 1.2	0.8 - 1.4	1.0 - 1.8	1.5 - 2.7
100	150 x 150	4.5	42	31	2.4 - 4.0	2.6 - 4.3	3.0 - 5.0	3.6 - 6.0
	200 x 200	2.5	21	25	2.0 - 2.8	2.2 - 3.3	2.6 - 4.0	3.2 - 4.6
	250 x 250	1.6	6	-	1.0 - 2.0	1.2 - 2.3	1.5 - 2.7	1.8 - 3.6
120	200 x 200	3.0	25	28	2.5 - 3.3	2.8 - 3.8	3.2 - 4.4	4.0 - 6.0
	250 x 250	1.9	9	-	1.2 - 2.4	1.5 - 2.7	2.0 - 3.5	2.5 - 4.3
	300 x 300	1.3	5	-	1.0 - 2.0	1.2 - 2.2	1.5 - 3.0	2.0 - 4.0
140	200 x 200	3.5	32	32	2.8 - 3.6	2.8 - 3.6	4.0 - 5.3	5.0 - 6.5
	250 x 250	2.3	13	22	1.5 - 3.0	1.5 - 3.5	2.5 - 4.2	3.0 - 5.0
	300 x 300	1.6	6	-	1.2 - 2.4	1.5 - 2.8	1.8 - 3.4	2.5 - 4.7
160	200 x 200	4.0	39	36	3.3 - 4.1	3.8 - 5.0	4.5 - 6.0	5.5 - 7.2
	250 x 250	2.6	19	25	1.9 - 3.5	2.3 - 4.0	2.8 - 4.8	3.3 - 5.6
	300 x 300	1.8	9	-	1.5 - 2.6	1.8 - 3.0	2.0 - 4.0	2.7 - 5.0
	350 x 350	1.3	4	-	1.2 - 2.2	1.5 - 2.5	1.8 - 3.0	2.0 - 4.0
180	200 x 200	4.5	46	40	3.6 - 4.7	4.3 - 5.6	5.2 - 7.0	6.2 - 8.0
	250 x 250	2.9	22	28	2.3 - 3.9	2.6 - 4.5	3.3 - 5.4	3.6 - 6.2
	300 x 300	2.0	11	18	1.7 - 2.9	2.1 - 3.2	2.3 - 4.3	3.0 - 5.5
	350 x 350	1.5	5	-	1.3 - 2.4	1.7 - 2.8	2.0 - 3.4	2.4 - 4.9
	400 x 400	1.1	3	-	1.0 - 2.2	1.4 - 2.3	1.7 - 3.0	2.2 - 4.4
200	250 x 250	3.2	26	31	2.6 - 4.5	3.0 - 5.0	3.6 - 6.0	4.0 - 6.8
	300 x 300	2.2	13	19	2.0 - 3.2	2.3 - 3.6	2.7 - 4.6	3.3 - 6.0
	350 x 350	1.6	7	-	1.6 - 2.8	2.0 - 3.2	2.3 - 4.0	2.8 - 5.5
	400 x 400	1.3	4	-	1.3 - 2.5	1.7 - 2.8	2.0 - 3.4	2.4 - 4.8
220	250 x 250	3.5	30	33	2.8 - 4.8	3.2 - 5.5	4.0 - 6.5	4.5 - 7.6
	300 x 300	2.5	16	21	2.2 - 3.6	2.6 - 4.0	3.0 - 4.9	3.8 - 6.6
	350 x 350	1.8	9	-	1.8 - 3.2	2.2 - 3.6	2.6 - 4.4	3.2 - 6.0
	400 x 400	1.4	5	-	1.4 - 2.7	1.8 - 3.1	2.3 - 3.9	2.9 - 5.4
240	250 x 250	3.8	37	36	3.2 - 5.6	3.6 - 6.2	4.3 - 7.0	5.0 - 8.4
	300 x 300	2.7	20	23	2.5 - 4.0	2.9 - 4.5	3.5 - 5.3	4.5 - 7.3
	350 x 350	2.0	11	19	2.1 - 3.6	2.4 - 4.0	3.0 - 4.8	3.6 - 6.5
	400 x 400	1.5	6	-	1.7 - 3.0	2.0 - 3.7	2.6 - 4.3	3.2 - 6.0
260	250 x 250	4.2	44	39	3.4 - 6.0	4.0 - 6.7	4.6 - 7.6	5.3 - 9.0
	300 x 300	2.9	23	25	2.7 - 4.3	3.2 - 5.0	3.7 - 6.0	4.7 - 8.0
	350 x 350	2.1	13	20	2.3 - 3.9	2.7 - 4.5	3.2 - 5.4	4.0 - 7.2
	400 x 400	1.6	7	-	2.0 - 3.2	2.3 - 4.0	2.8 - 4.6	3.5 - 6.6
280	250 x 250	4.5	52	42	3.7 - 6.5	4.3 - 7.6	5.0 - 8.3	5.7 - 9.8
	300 x 300	3.1	27	28	3.0 - 4.8	3.5 - 5.5	4.0 - 6.6	5.0 - 8.5
	350 x 350	2.3	16	22	2.6 - 4.3	3.0 - 5.0	3.5 - 6.0	4.5 - 7.7
	400 x 400	1.8	9	-	2.2 - 3.5	2.6 - 4.2	3.0 - 5.0	3.6 - 7.2
	450 x 450	1.4	6	-	1.8 - 3.2	2.2 - 3.7	2.6 - 4.2	3.2 - 6.5
300	300 x 300	3.3	29	30	3.2 - 5.2	3.7 - 5.8	4.3 - 6.8	5.3 - 9.0
	350 x 350	2.5	18	23	2.8 - 4.6	3.3 - 5.2	3.7 - 6.3	4.8 - 8.2
	400 x 400	1.9	10	18	2.4 - 3.8	2.8 - 4.6	3.3 - 5.5	3.9 - 7.8
	450 x 450	1.5	7	-	1.9 - 3.2	2.4 - 4.0	2.8 - 4.4	3.3 - 6.8
	500 x 500	1.2	3	-	1.5 - 3.0	2.0 - 3.4	2.2 - 3.8	2.7 - 5.5
320	300 x 300	3.6	32	32	3.5 - 5.6	4.0 - 6.0	4.6 - 7.2	5.7 - 9.5
	350 x 350	2.6	21	25	3.0 - 4.8	3.6 - 5.4	4.1 - 6.7	5.1 - 8.6
	400 x 400	2.0	11	19	2.6 - 4.0	3.3 - 5.0	3.6 - 6.0	4.3 - 8.0
	450 x 450	1.6	8	-	2.1 - 3.5	2.6 - 4.3	3.0 - 4.7	3.6 - 7.2
	500 x 500	1.3	4	-	1.7 - 3.2	2.2 - 3.7	2.5 - 4.2	3.0 - 6.2

Series DG Technical Data Multi-Cone Diffusers

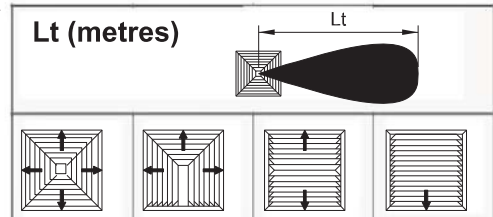
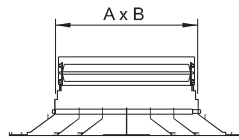

q (l/s)	A x B	Vn (M/s)	Ps (Pascals)	NC	4A (4 - Way)	3A (3 - Way)	2A (2 - Way)	1A (1 - Way)
340	300 x 300	3.8	36	34	3.7 - 5.8	4.2 - 6.3	4.8 - 7.5	6.0 - 10.2
	350 x 350	2.8	24	27	3.2 - 5.1	3.8 - 5.8	4.3 - 7.1	5.3 - 8.8
	400 x 400	2.1	13	21	2.8 - 4.2	3.5 - 5.3	3.8 - 6.3	4.5 - 8.3
	450 x 450	1.7	10	-	2.2 - 3.7	2.8 - 4.6	3.2 - 5.1	4.0 - 7.7
	500 x 500	1.4	5	-	1.8 - 3.4	2.3 - 3.9	2.7 - 4.5	3.5 - 7.0
360	300 x 300	4.0	42	36	3.9 - 6.0	4.5 - 6.8	5.1 - 7.7	6.2 - 10.8
	350 x 350	3.0	27	31	3.4 - 5.4	4.0 - 6.2	4.6 - 7.4	5.5 - 9.0
	400 x 400	2.3	16	23	3.0 - 4.5	3.7 - 5.6	4.1 - 6.6	4.7 - 8.6
	450 x 450	1.8	12	18	2.5 - 4.0	3.0 - 4.8	3.5 - 5.5	4.3 - 8.0
	500 x 500	1.5	7	-	2.0 - 3.7	2.5 - 4.2	3.0 - 5.0	4.0 - 7.6
	600 x 600	1.0	4	-	1.4 - 2.6	-	-	-
380	300 x 300	4.2	47	39	4.2 - 6.5	5.2 - 7.5	5.7 - 8.5	-
	350 x 350	3.1	30	32	3.7 - 5.7	4.2 - 6.6	4.9 - 7.6	5.8 - 9.3
	400 x 400	2.4	18	25	3.3 - 4.9	4.0 - 5.9	4.2 - 6.9	5.0 - 9.0
	450 x 450	1.9	14	20	2.7 - 4.2	3.2 - 5.1	3.7 - 5.8	4.7 - 8.5
	500 x 500	1.5	8	-	2.1 - 3.9	2.6 - 4.4	3.2 - 5.3	4.2 - 8.0
	600 x 600	1.1	4	-	1.6 - 3.0	-	-	-
400	300 x 300	4.5	54	43	4.5 - 7.0	-	-	-
	350 x 350	3.3	33	34	4.0 - 6.0	4.4 - 7.0	5.2 - 7.9	6.2 - 10.5
	400 x 400	2.5	21	27	3.5 - 5.2	4.2 - 6.2	4.5 - 7.2	5.2 - 9.3
	450 x 450	2.0	16	22	2.9 - 4.3	3.4 - 3.5	3.9 - 6.1	5.0 - 9.0
	500 x 500	1.6	10	-	2.3 - 4.2	2.8 - 4.7	3.4 - 5.5	4.5 - 8.3
	600 x 600	1.1	4	-	1.8 - 3.6	-	-	-
420	350 x 350	3.4	36	36	4.3 - 6.5	4.6 - 7.4	5.5 - 8.4	6.5 - 11.3
	400 x 400	2.6	23	29	3.7 - 5.5	4.4 - 6.7	4.7 - 7.6	5.5 - 10.0
	450 x 450	2.1	17	23	3.1 - 4.6	3.6 - 5.7	4.1 - 6.5	5.3 - 9.5
	500 x 500	1.7	11	-	2.4 - 4.4	3.0 - 5.1	3.6 - 6.2	4.7 - 8.6
	600 x 600	1.2	5	-	2.0 - 3.8	-	-	-
	450	350 x 350	3.7	40	38	4.6 - 7.0	4.9 - 7.7	5.6 - 8.7
400 x 400	2.8	26	31	3.9 - 6.0	4.6 - 7.2	5.0 - 8.0	5.7 - 10.5	
450 x 450	2.2	19	25	3.3 - 5.0	3.8 - 6.0	4.3 - 7.0	5.6 - 9.8	
500 x 500	1.8	12	18	2.6 - 4.6	3.3 - 5.5	3.9 - 6.6	5.2 - 9.0	
600 x 600	1.3	5	-	2.2 - 4.0	-	-	-	
500	400 x 400	3.1	32	34	4.2 - 6.5	4.8 - 8.0	5.5 - 9.0	6.2 - 11.4
	450 x 450	2.5	23	28	3.5 - 5.5	4.2 - 6.6	4.7 - 7.5	6.1 - 10.7
	500 x 500	2.0	15	22	2.9 - 5.1	3.6 - 6.0	4.3 - 7.1	5.7 - 10.0
	600 x 600	1.4	7	18	2.5 - 4.4	-	-	-
550	400 x 400	3.4	38	38	4.6 - 7.2	5.3 - 8.7	6.0 - 10.0	7.0 - 12.0
	450 x 450	2.7	29	32	3.8 - 6.0	4.6 - 7.0	5.1 - 8.2	6.6 - 11.3
	500 x 500	2.2	18	26	3.2 - 5.7	3.8 - 6.8	4.7 - 7.8	6.2 - 10.3
	600 x 600	1.5	10	20	2.8 - 5.0	-	-	-
600	450 x 450	3.0	33	35	4.1 - 6.4	4.8 - 7.6	5.5 - 8.7	7.1 - 12.0
	500 x 500	2.4	21	28	3.5 - 6.2	4.1 - 7.1	5.0 - 8.2	6.5 - 11.0
	600 x 600	1.7	12	22	3.0 - 5.5	-	-	-
650	450 x 450	3.2	38	38	4.3 - 7.1	5.2 - 8.4	5.7 - 9.5	7.5 - 12.8
	500 x 500	2.6	25	31	3.7 - 6.5	4.4 - 7.8	5.2 - 9.0	7.0 - 12.0
	600 x 600	1.8	14	24	3.3 - 6.2	-	-	-
700	500 x 500	2.8	29	33	4.2 - 7.3	4.8 - 8.5	5.7 - 10.0	7.5 - 13.0
	600 x 600	2.0	17	26	3.5 - 6.5	-	-	-
750	500 x 500	3.0	32	35	4.5 - 7.8	5.2 - 8.8	6.0 - 10.5	7.7 - 13.5
	600 x 600	2.1	19	28	3.6 - 6.9	-	-	-
800	500 x 500	3.2	35	39	4.8 - 8.0	5.5 - 9.2	6.3 - 11.0	8.0 - 14.0
	600 x 600	2.2	22	30	3.8 - 7.2	-	-	-
1000	600 x 600	2.8	33	37	5.0 - 10.0	-	-	-

Series DG Technical Data Multi-Cone Diffusers

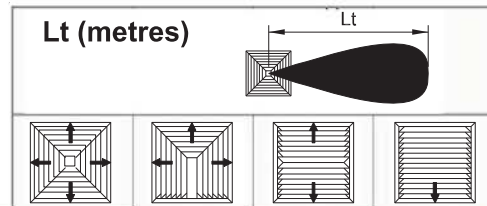
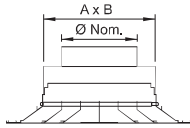

q (l/s)	Ø	A x B	Vn (M/s)	Ps (Pascals)	NC	4A (4 - Way)	3A (3 - Way)	2A (2 - Way)	1A (1 - Way)
30	150	200 x 200	1.7	4	-	0.8 - 1.2	1.0 - 1.5	1.2 - 1.7	1.5 - 2.0
	150	300 x 300	1.7	3	-	0.7 - 1.0	0.8 - 1.2	1.0 - 1.4	1.2 - 1.6
	150	400 x 400	1.7	1	-	0.6 - 0.9	0.7 - 1.0	0.8 - 1.2	1.0 - 1.5
40	150	200 x 200	2.3	6	-	1.0 - 1.4	1.2 - 1.7	1.4 - 2.0	1.7 - 2.3
	150	300 x 300	2.3	4	-	0.8 - 1.2	1.0 - 1.4	1.2 - 1.7	1.5 - 2.1
	150	400 x 400	2.3	2	-	0.7 - 1.0	0.8 - 1.1	1.0 - 1.5	1.3 - 1.9
60	150	500 x 500	2.3	1	-	-	-	0.9 - 1.3	1.2 - 1.7
	150	200 x 200	3.4	9	21	1.3 - 1.8	1.5 - 2.0	1.9 - 2.6	2.2 - 3.2
	150	300 x 300	3.4	6	19	1.1 - 1.5	1.4 - 1.8	1.7 - 2.4	2.0 - 3.0
80	150	400 x 400	3.4	5	18	1.0 - 1.3	1.2 - 1.6	1.5 - 2.0	1.8 - 2.8
	150	500 x 500	3.4	3	17	1.0 - 1.2	1.2 - 1.5	1.4 - 1.8	1.6 - 2.3
	200	300 x 300	1.9	2	-	0.8 - 1.0	1.0 - 1.3	1.2 - 1.7	1.4 - 2.0
100	150	200 x 200	4.5	15	26	1.8 - 2.5	2.0 - 2.7	2.5 - 3.2	3.0 - 4.0
	150	300 x 300	4.5	10	24	1.4 - 2.2	1.8 - 2.2	2.2 - 3.0	2.8 - 4.0
	150	400 x 400	4.5	8	23	1.3 - 1.8	1.5 - 2.0	1.9 - 2.8	2.5 - 3.7
	150	500 x 500	4.5	7	20	1.2 - 1.6	1.3 - 1.8	1.6 - 2.2	2.0 - 3.0
	200	300 x 300	2.5	5	20	1.2 - 1.5	1.3 - 1.6	1.5 - 2.1	2.0 - 2.8
	200	400 x 400	2.5	4	17	1.1 - 1.5	1.2 - 1.6	1.3 - 2.0	1.8 - 2.6
	200	500 x 500	2.5	3	-	1.0 - 1.4	1.2 - 1.6	1.3 - 1.8	1.8 - 2.4
120	150	200 x 200	5.7	20	31	2.3 - 3.1	2.5 - 3.3	3.0 - 4.3	3.7 - 4.8
	150	300 x 300	5.7	14	29	2.0 - 2.7	2.2 - 2.8	2.7 - 3.8	3.4 - 4.6
	150	400 x 400	5.7	12	26	1.8 - 2.5	2.0 - 2.7	2.6 - 3.5	3.3 - 4.4
	150	500 x 500	5.7	10	23	1.7 - 2.3	2.0 - 2.6	2.4 - 3.1	3.1 - 4.0
	200	300 x 300	3.2	8	22	1.7 - 2.3	2.0 - 2.6	2.2 - 3.0	3.0 - 4.0
	200	400 x 400	3.2	7	20	1.6 - 2.1	1.9 - 2.4	2.2 - 2.8	2.8 - 3.8
	200	500 x 500	3.2	5	17	1.5 - 2.0	1.7 - 2.2	2.0 - 2.6	2.5 - 3.5
140	250	300 x 300	2.0	9	-	1.5 - 2.0	1.8 - 2.5	2.5 - 3.2	3.0 - 4.0
	150	200 x 200	6.8	29	35	2.8 - 3.8	3.1 - 4.2	3.7 - 5.0	4.4 - 6.0
	150	300 x 300	6.8	20	33	2.5 - 3.2	2.7 - 3.6	3.2 - 4.3	3.8 - 5.5
	150	400 x 400	6.8	18	30	2.2 - 3.0	2.5 - 3.4	2.9 - 4.1	3.8 - 5.3
	150	500 x 500	6.8	15	26	2.0 - 2.8	2.2 - 3.0	2.6 - 3.8	3.5 - 5.0
	200	300 x 300	3.8	11	26	2.0 - 2.7	2.1 - 2.8	2.5 - 3.5	3.3 - 4.4
	200	400 x 400	3.8	9	24	1.8 - 2.5	2.0 - 2.7	2.5 - 3.5	3.2 - 4.2
160	200	500 x 500	3.8	7	20	1.6 - 2.1	1.8 - 2.5	2.3 - 3.2	2.9 - 4.0
	250	300 x 300	2.5	10	18	2.0 - 2.7	2.2 - 2.9	2.5 - 3.5	3.2 - 4.5
	250	400 x 400	2.5	9	17	2.0 - 2.6	2.1 - 2.8	2.2 - 3.0	2.8 - 3.6
	200	300 x 300	4.5	16	30	2.4 - 3.2	2.6 - 3.6	3.3 - 4.2	4.1 - 5.3
	200	400 x 400	4.5	14	28	2.0 - 3.0	2.4 - 3.4	3.2 - 4.2	3.9 - 5.1
	200	500 x 500	4.5	10	25	1.8 - 2.8	2.2 - 3.1	3.0 - 4.0	3.7 - 4.9
	250	300 x 300	2.9	13	21	2.0 - 2.8	2.2 - 3.0	2.7 - 3.8	3.5 - 4.6
180	250	400 x 400	2.9	11	20	1.9 - 2.6	2.2 - 2.8	2.7 - 3.6	3.3 - 4.4
	250	500 x 500	2.9	7	18	1.6 - 2.4	2.0 - 2.8	2.7 - 3.3	3.2 - 4.4
	200	300 x 300	5.1	18	32	2.7 - 3.5	3.0 - 4.0	3.8 - 5.0	4.5 - 6.0
	200	400 x 400	5.1	14	30	2.4 - 3.3	2.8 - 3.7	3.6 - 4.8	4.4 - 5.8
	200	500 x 500	5.1	12	27	2.2 - 3.2	2.6 - 3.5	3.4 - 4.6	4.2 - 5.4
	250	300 x 300	3.3	15	22	2.4 - 3.5	2.5 - 3.5	3.2 - 4.4	4.0 - 5.0
	250	400 x 400	3.3	12	21	2.1 - 3.0	2.4 - 3.3	3.0 - 4.2	3.8 - 4.8
200	250	500 x 500	3.3	8	19	1.8 - 2.7	2.3 - 3.0	3.0 - 4.0	3.6 - 5.0
	200	300 x 300	5.7	23	34	3.0 - 4.0	3.5 - 4.5	4.2 - 5.4	5.0 - 6.5
	200	400 x 400	5.7	20	33	2.8 - 3.8	3.3 - 4.4	4.1 - 5.2	4.9 - 6.4
	200	500 x 500	5.7	15	30	2.5 - 3.5	3.0 - 4.0	3.9 - 5.0	4.6 - 6.2
	250	300 x 300	3.7	17	24	2.5 - 3.3	3.0 - 3.8	3.8 - 4.8	4.6 - 6.0
	250	400 x 400	3.7	14	23	2.4 - 3.2	2.8 - 3.6	3.7 - 4.6	4.5 - 5.6
	250	500 x 500	3.7	9	21	2.1 - 3.0	2.6 - 3.3	3.5 - 4.4	4.2 - 5.5
200	200	300 x 300	6.4	28	36	3.2 - 4.2	3.7 - 4.8	4.6 - 6.0	5.6 - 7.2
	200	400 x 400	6.4	22	34	3.0 - 4.1	3.5 - 4.8	4.5 - 5.7	5.4 - 7.0
	200	500 x 500	6.4	17	31	2.7 - 3.8	3.3 - 4.2	4.2 - 5.5	5.1 - 6.5
	250	300 x 300	4.1	20	26	2.7 - 3.7	3.3 - 4.2	4.0 - 5.3	5.0 - 6.5
	250	400 x 400	4.1	16	25	2.5 - 3.5	3.0 - 4.0	3.8 - 5.0	4.7 - 6.2
	250	500 x 500	4.1	11	23	2.2 - 3.2	2.8 - 3.7	3.6 - 4.7	4.4 - 5.8
	300	400 x 400	2.8	8	19	2.0 - 3.0	2.5 - 3.6	3.5 - 4.5	4.5 - 6.0
	300	500 x 500	2.8	8	18	1.8 - 2.7	2.3 - 3.2	3.0 - 4.0	4.0 - 5.2
	350	400 x 400	2.1	7	18	1.8 - 3.0	2.5 - 3.5	3.0 - 4.2	4.2 - 5.5
350	500 x 500	2.1	6	17	1.5 - 2.5	2.0 - 3.0	2.7 - 3.8	3.6 - 4.9	

Series DG Technical Data Multi-Cone Diffusers

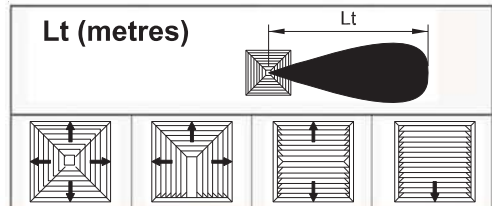
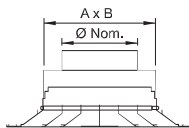

q (l/s)	Ø	A x B	Vn (M/s)	Ps (Pascals)	NC	4A (4 - Way)	3A (3 - Way)	2A (2 - Way)	1A (1 - Way)
220	200	300 x 300	7.0	30	38	3.5 - 4.5	4.0 - 5.0	5.0 - 6.3	6.0 - 7.5
	200	400 x 400	7.0	26	36	3.3 - 4.3	3.8 - 4.8	4.8 - 6.0	5.8 - 7.3
	200	500 x 500	7.0	20	33	3.0 - 4.0	3.6 - 4.4	4.5 - 5.8	5.5 - 6.9
	250	300 x 300	4.5	23	30	3.0 - 4.0	3.4 - 4.2	4.2 - 5.5	5.3 - 6.5
	250	400 x 400	4.5	20	29	2.7 - 3.8	3.2 - 4.1	4.0 - 5.3	5.1 - 6.3
	250	500 x 500	4.5	15	26	2.4 - 3.4	3.0 - 4.0	3.8 - 5.0	4.8 - 6.0
	300	400 x 400	3.1	13	23	2.4 - 3.4	3.0 - 4.0	3.6 - 4.8	4.5 - 5.8
	300	500 x 500	3.1	12	22	2.2 - 3.2	2.8 - 3.8	3.4 - 4.6	4.4 - 5.6
	350	400 x 400	2.3	10	20	2.0 - 3.0	2.8 - 3.8	3.4 - 4.4	4.4 - 5.4
	350	500 x 500	2.3	8	18	1.8 - 2.9	2.6 - 3.4	3.2 - 4.4	4.4 - 5.4
240	250	300 x 300	4.9	28	32	3.3 - 4.3	3.7 - 4.6	4.6 - 6.2	5.8 - 7.2
	250	400 x 400	4.9	23	30	3.0 - 4.0	3.4 - 4.2	4.3 - 5.8	5.4 - 6.6
	250	500 x 500	4.9	18	28	2.8 - 3.7	3.2 - 4.0	4.0 - 5.5	5.1 - 6.2
	300	400 x 400	3.4	14	24	2.8 - 3.7	3.2 - 4.2	4.0 - 5.3	4.8 - 6.0
	300	500 x 500	3.4	13	23	2.4 - 3.5	3.0 - 4.0	3.6 - 5.0	4.5 - 5.7
	350	400 x 400	2.5	11	21	2.2 - 3.2	2.8 - 3.8	3.4 - 4.8	4.5 - 5.7
	350	500 x 500	2.5	9	19	2.0 - 3.0	2.6 - 3.5	3.2 - 4.5	4.5 - 5.7
260	250	300 x 300	5.3	32	35	3.5 - 4.6	4.0 - 5.0	5.0 - 7.0	6.2 - 7.8
	250	400 x 400	5.3	27	32	3.3 - 4.4	3.7 - 4.5	4.5 - 6.6	5.8 - 7.2
	250	500 x 500	5.3	22	30	3.0 - 4.0	3.5 - 4.3	4.3 - 6.2	5.5 - 7.0
	300	400 x 400	3.7	16	26	2.8 - 3.8	3.4 - 4.1	4.3 - 6.0	5.2 - 6.8
	300	500 x 500	3.7	14	24	2.6 - 3.5	3.2 - 4.0	4.0 - 5.5	5.0 - 6.5
	350	400 x 400	2.7	13	23	2.4 - 3.4	3.0 - 4.0	3.9 - 5.5	4.8 - 6.3
	350	500 x 500	2.7	11	20	2.3 - 3.1	2.8 - 3.7	3.7 - 5.0	4.5 - 6.0
280	250	300 x 300	5.7	35	38	3.7 - 4.9	4.2 - 5.2	5.4 - 7.2	6.8 - 8.3
	250	400 x 400	5.7	31	36	3.4 - 4.7	3.9 - 4.8	5.0 - 6.9	6.8 - 8.0
	250	500 x 500	5.7	25	33	3.2 - 4.3	3.7 - 4.7	4.7 - 6.6	6.0 - 7.7
	300	400 x 400	4.0	20	29	3.2 - 4.5	3.6 - 4.5	4.7 - 6.4	5.8 - 7.5
	300	500 x 500	4.0	18	26	2.9 - 3.8	3.4 - 4.3	4.5 - 6.1	5.6 - 7.3
	350	400 x 400	2.9	15	25	2.7 - 3.5	3.1 - 4.0	4.5 - 6.0	5.5 - 7.0
	350	500 x 500	2.9	13	22	2.5 - 3.2	2.9 - 3.8	4.3 - 5.7	5.3 - 7.0
300	250	300 x 300	6.1	40	43	3.9 - 5.2	4.5 - 5.6	6.0 - 7.5	7.3 - 8.8
	250	400 x 400	6.1	35	41	3.6 - 5.0	4.3 - 5.3	5.8 - 7.3	7.1 - 8.6
	250	500 x 500	6.1	28	38	3.5 - 4.5	4.0 - 5.0	5.4 - 7.0	6.7 - 8.5
	300	400 x 400	4.2	25	32	3.5 - 4.5	4.0 - 5.0	5.2 - 6.8	6.5 - 8.2
	300	500 x 500	4.2	20	29	3.2 - 4.2	3.5 - 4.5	5.2 - 6.8	6.5 - 8.2
	350	400 x 400	3.1	18	27	3.0 - 4.0	3.4 - 4.5	5.2 - 6.7	6.3 - 8.0
	350	500 x 500	3.1	16	25	2.8 - 3.6	3.3 - 4.2	5.0 - 6.3	6.0 - 7.5
320	250	500 x 500	6.5	32	40	3.8 - 5.0	4.4 - 5.8	5.8 - 7.3	7.2 - 9.0
	300	400 x 400	4.5	27	34	3.7 - 4.7	4.2 - 5.3	5.4 - 7.0	6.8 - 8.5
	300	500 x 500	4.5	22	30	3.4 - 4.4	3.8 - 5.0	5.2 - 6.5	6.3 - 8.0
	350	400 x 400	3.3	21	30	3.3 - 4.2	3.6 - 4.7	4.9 - 6.3	6.0 - 7.5
	350	500 x 500	3.3	18	26	3.0 - 4.0	3.6 - 4.6	4.6 - 6.1	6.0 - 7.5
340	250	500 x 500	6.9	37	43	4.2 - 5.5	5.0 - 6.4	6.2 - 7.6	7.8 - 9.5
	300	400 x 400	4.8	29	37	4.0 - 5.0	4.5 - 5.6	5.8 - 7.0	7.2 - 9.0
	300	500 x 500	4.8	25	32	3.7 - 4.8	4.2 - 5.4	5.4 - 6.8	6.6 - 8.5
	350	400 x 400	3.6	24	32	3.6 - 4.6	4.0 - 5.1	5.2 - 6.6	6.3 - 8.0
	350	500 x 500	3.6	21	29	3.4 - 4.3	3.8 - 4.8	5.1 - 6.5	6.3 - 8.0
370	300	400 x 400	5.2	31	38	4.6 - 6.0	5.0 - 6.2	6.6 - 8.2	7.6 - 9.5
	300	500 x 500	5.2	28	34	4.1 - 5.4	4.5 - 5.8	6.0 - 7.5	7.0 - 9.0
	350	400 x 400	3.9	26	34	4.0 - 5.4	4.2 - 5.6	5.6 - 7.2	6.6 - 8.5
	350	500 x 500	3.9	22	31	3.7 - 4.8	4.0 - 5.3	5.5 - 7.0	6.5 - 8.5
400	300	400 x 400	5.7	33	39	5.0 - 6.3	5.5 - 6.6	7.0 - 8.7	8.0 - 10.0
	300	500 x 500	5.7	30	36	4.5 - 6.0	4.8 - 6.3	6.5 - 8.4	7.4 - 9.4
	350	400 x 400	4.2	28	35	4.3 - 5.7	4.5 - 6.0	6.3 - 8.2	7.2 - 9.3
	350	500 x 500	4.2	23	33	4.0 - 5.5	4.3 - 5.7	6.0 - 8.0	7.0 - 9.0
450	300	400 x 400	6.4	38	43	5.5 - 6.9	6.2 - 7.4	7.6 - 9.3	9.0 - 11.5
	300	500 x 500	6.4	36	40	5.0 - 6.4	5.5 - 7.0	7.2 - 8.8	8.2 - 10.5
	350	400 x 400	4.7	34	39	5.0 - 6.2	5.5 - 7.0	6.9 - 8.5	8.0 - 10.0
	350	500 x 500	4.7	28	36	4.5 - 5.8	4.9 - 6.3	6.4 - 8.0	7.6 - 10.0
500	350	400 x 400	5.2	41	44	5.7 - 6.9	6.2 - 7.7	8.0 - 10.0	9.5 - 12.0
	350	500 x 500	5.2	36	42	5.2 - 6.5	5.6 - 7.0	7.0 - 9.0	8.5 - 11.0

Series DG

Technical Data Multi-Cone Diffusers (Extract)



A x B	Nomenclature	Vn (Ms)	Vn (Ms)	Vn (Ms)	Vn (Ms)	Vn (Ms)	Vn (Ms)	Vn (Ms)	Vn (Ms)	Vn (Ms)
		1.0	1.25	1.50	1.75	2.0	2.25	2.50	2.75	3.0
150 x 150 An .0225 M ²	q (l/s)	-	30	35	40	45	50	55	60	65
	Psn (Pa)	-	9	9	11	13	18	21	24	30
	Vf (M/s)	-	.52	.60	.69	.78	.87	.95	1.04	1.13
	NC	-	-	-	-	-	-	17	20	23
200 x 200 An .04 M ²	q (l/s)	40	50	60	70	80	90	100	110	120
	Psn (Pa)	9	10	10	13	16	20	24	29	36
	Vf (M/s)	.48	.59	.71	.83	.95	1.07	1.19	1.30	1.43
	NC	-	-	-	17	18	19	21	22	25
300 x 150 An .045 M ²	q (l/s)	45	55	70	80	90	100	110	120	130
	Psn (Pa)	9	10	10	14	20	25	30	35	43
	Vf (M/s)	.48	.59	.75	.85	.96	1.07	1.18	1.28	1.39
	NC	-	-	17	18	19	20	23	26	28
250 x 250 An .0625 M ²	q (l/s)	65	80	95	110	125	140	155	170	185
	Psn (Pa)	9	10	10	12	17	21	25	30	35
	Vf (M/s)	.56	.69	.82	.95	1.08	1.21	1.34	1.47	1.60
	NC	-	-	-	-	18	21	24	28	30
450 x 150 An .0675 M ²	q (l/s)	70	85	100	115	135	150	170	185	200
	Psn (Pa)	12	15	18	23	31	39	47	55	66
	Vf (M/s)	.54	.65	.77	.88	1.04	1.15	1.31	1.42	1.54
	NC	-	-	-	-	18	21	24	28	30
300 x 300 An .09 M ²	q (l/s)	90	115	135	160	180	200	225	245	270
	Psn (Pa)	9	10	11	13	17	21	24	29	35
	Vf (M/s)	.59	.76	.89	1.05	1.18	1.31	1.48	1.61	1.78
	NC	-	-	17	18	21	24	28	32	34
500 x 200 An .010 M ²	q (l/s)	100	125	150	175	200	225	250	275	300
	Psn (Pa)	11	12	14	19	25	30	36	43	52
	Vf (M/s)	.59	.74	.88	1.03	1.18	1.32	1.47	1.61	1.75
	NC	-	-	17	19	21	24	28	33	35
350 x 350 An .1225 M ²	q (l/s)	120	150	185	215	245	275	305	335	365
	Psn (Pa)	11	12	14	18	23	28	34	39	46
	Vf (M/s)	.62	.74	.96	1.11	1.27	1.42	1.58	1.73	1.89
	NC	-	-	16	18	22	25	29	33	37
450 x 300 An .135 M ²	q (l/s)	135	165	200	235	270	300	335	370	405
	Psn (Pa)	11	11	13	17	22	27	33	39	47
	Vf (M/s)	.64	.79	.95	1.12	1.29	1.43	1.60	1.76	1.92
	NC	-	-	17	19	22	25	29	33	37
400 x 400 An .16 M ²	q (l/s)	160	200	240	280	320	360	400	440	480
	Psn (Pa)	11	12	14	18	24	31	37	43	52
	Vf (M/s)	.66	.83	1.0	1.16	1.33	1.50	1.66	1.83	2.0
	NC	-	17	19	20	23	25	30	35	39
600 x 300 An .18 M ²	q (l/s)	180	225	270	315	360	400	450	495	540
	Psn (Pa)	12	13	17	22	31	38	46	54	64
	Vf (M/s)	.66	.83	1.0	1.17	1.34	1.49	1.67	1.84	2.0
	NC	17	18	20	22	26	29	34	36	41
450 x 450 An .2025 M ²	q (l/s)	200	250	300	350	400	450	500	550	600
	Psn (Pa)	12	13	17	21	27	34	41	48	57
	Vf (M/s)	.68	.86	1.03	1.20	1.37	1.54	1.71	1.90	2.07
	NC	18	20	21	23	28	32	36	38	42
500 x 500 An .25 M ²	q (l/s)	250	310	375	435	500	560	625	685	750
	Psn (Pa)	12	14	17	21	27	34	42	49	59
	Vf (M/s)	.71	.89	1.08	1.25	1.44	1.61	1.80	1.97	2.16
	NC	18	20	22	25	30	34	37	40	45
550 x 550 An .3025 M ²	q (l/s)	300	375	450	525	600	675	750	830	905
	Psn (Pa)	12	14	18	23	31	38	46	54	65
	Vf (M/s)	.73	.91	1.10	1.28	1.46	1.65	1.83	2.02	2.20
	NC	19	21	23	27	33	36	38	42	47
600 x 600 An .36 M ²	q (l/s)	360	450	540	630	720	810	900	990	1080
	Psn (Pa)	13	16	21	26	35	41	47	56	67
	Vf (M/s)	.76	.95	1.13	1.32	1.51	1.70	1.89	2.08	2.27
	NC	21	23	25	29	35	39	43	45	48

Series GRC

Fixed Circular Diffusers



Description

For supply or extract air, fixed blade multicone ceiling diffuser with countersunk flange holes for easy fixing. Suitable for ceiling and duct mounting.

Construction

From presses mild steel outer frame and inner cores. Optional damper has twin blades with opposed action operated via screwdriver through the face of diffuser.

Size

From 160mm dia. To 315mm dia. Neck sizes.

How to Specify

State Quantity, the series, product coding and the size width x height e.g **10 Qty. GRCCSE0TBD+1X 315Ø**



Series	Frame Style	Options		Options		Accessories		+	Fixing	Finish		
GRC	CS	Circular Steel	0	None	0	None	0		None	1	Flanges Holes	X
			E	Extended Neck Collar	Q	Square Duct Plenum	TBD	Twin Blade Damper			Y	PPC BS/Ral Colour
					P	Spiral Duct Plenum	FPD	Flat Plate Damper				

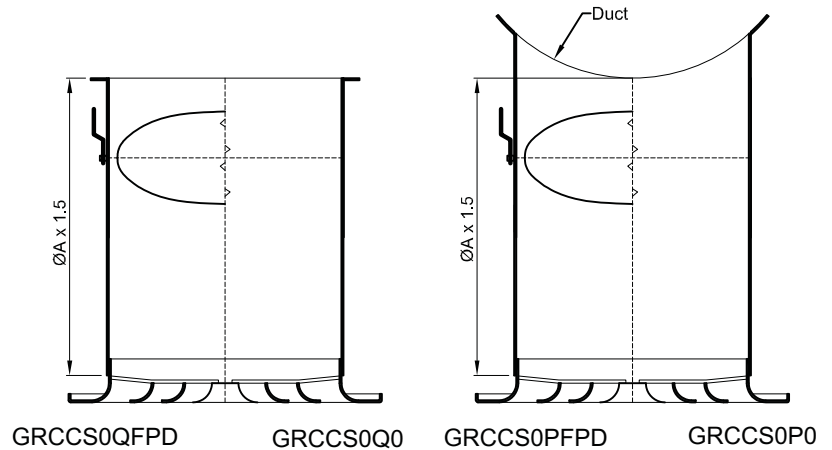
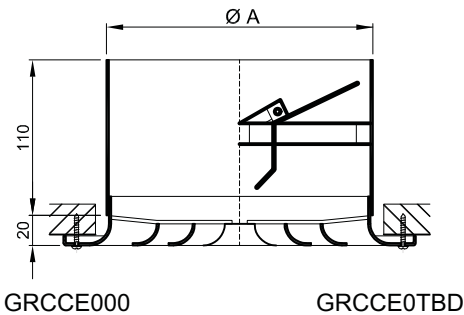
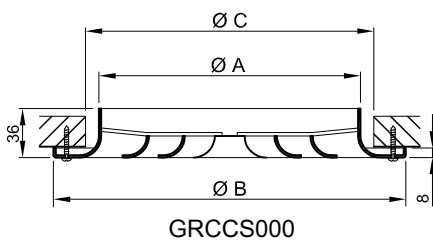

Series GRC

Technical Data Fixed Pattern Circular



Fixed Pattern Diffuser

The 'CS000' is an effective and efficient 'low-cost' ceiling diffuser. Suitable for cooling temperature differentials (Td) to - 14° and heating Td to +30°. An ideal product for low ceiling installations. Fixed tamperproof cone assembly. The optional twin blade opposed action volume control damper is allen key operated via the diffuser centre cone.

Performance Data

Values are based upon a 2.7 metre high ceiling flush and free of obtrusions, a temperature differential of 10° C and the rear volume control damper set in the fully open position.

Noise Criteria

Noise ratings in the form of 'NC' levels are given in the performance Tables and are based on an 8dB deduction for average room Absorption and sound power level (LW) 10⁻¹² W.

Damper influence

Data includes the fitting of rear twin blade (opposed action) damper set in the fully open position. Harsh throttling of the damper may adversely affect pressure drop and noise and should be avoided. Should a rear volume control damper not be required the resultant reduction in pressure drop and noise rating will be:

Ps x 0.85
NC -5

Throw (Lt) and terminal velocity (Vt)

Throw values 'Lt' given in the table is the radial distance in meters from the diffuser centre. The shorter 'Lt' distance shown is that point at which the airstream has been reduced to a terminal velocity (Vt) of 0.5M/s and the longer throw 'Lt' is that distance at which 'Vt' is 0.25M/s.

Ak Factors

Outlet areas in M² are given in table in the form of Ak values.

$$q \text{ (l/s)} = V_k \times A_k \times 1000$$

Ø A	An (M ²)	AK (M ²)	Nomenclature	Vn(M/s)						
				2.0	2.5	3.0	3.5	4.0	4.5	5.0
Ø 150	0.016	0.011	q (l/s)	30	40	50	60	70	80	-
			Lt (meters)	0.7	0.9 - 1.5	1.0 - 1.8	1.2 - 1.8	1.5 - 2.0	1.7 - 2.6	-
			Ps (Pascals)	8	9	12	17	23	32	-
			NC	-	16	21	26	32	40	-
Ø 200	0.028	0.020	q (l/s)	70	80	90	100	110	120	140
			Lt (meters)	0.9 - 1.5	1.2 - 1.8	1.4 - 2.2	1.5 - 2.4	1.8 - 2.6	2.0 - 3.0	2.3 - 3.4
			Ps (Pascals)	8	11	14	17	21	25	33
			NC	15	21	25	28	32	37	42
Ø 250	0.045	0.031	q (l/s)	100	120	140	160	180	200	220
			Lt (meters)	1.0 - 1.7	1.4 - 2.2	1.7 - 2.6	1.8 - 3.0	2.2 - 3.3	2.4 - 3.8	2.6 - 4.2
			Ps (Pascals)	7	9	13	17	19	23	27
			NC	16	22	27	32	35	39	42
Ø 300	0.065	0.045	q (l/s)	140	170	210	240	270	300	330
			Lt (meters)	1.5 - 2.1	1.8 - 2.7	2.1 - 3.0	2.4 - 3.3	2.6 - 3.7	2.9 - 4.3	3.5 - 5.0
			Ps (Pascals)	6	8	14	18	21	28	33
			NC	16	22	27	32	35	39	42
Ø 350	0.087	0.061	q (l/s)	170	210	250	290	330	370	410
			Lt (meters)	1.7 - 2.6	2.1 - 2.9	2.5 - 3.4	2.9 - 4.0	3.1 - 4.3	3.4 - 4.8	3.9 - 5.4
			Ps (Pascals)	6	7	13	18	20	25	30
			NC	17	23	29	34	38	40	43
Ø 400	0.115	0.080	q (l/s)	200	250	300	350	400	450	500
			Lt (meters)	2.0 - 2.9	2.4 - 3.3	2.9 - 3.8	3.4 - 4.5	3.7 - 5.0	4.0 - 5.2	4.4 - 5.9
			Ps (Pascals)	6	8	13	18	21	27	29
			NC	17	23	30	34	37	41	43
Ø 450	0.145	0.100	q (l/s)	240	300	360	420	480	540	600
			Lt (meters)	2.5 - 3.5	2.9 - 3.9	3.3 - 4.4	3.8 - 5.0	4.2 - 5.5	4.7 - 6.0	5.1 - 6.5
			Ps (Pascals)	5	7	12	17	20	28	30
			NC	18	24	30	36	38	42	44
Ø 500	0.178	0.125	q (l/s)	280	340	400	460	520	580	640
			Lt (meters)	2.8 - 3.8	3.2 - 4.2	3.7 - 4.8	4.1 - 5.3	4.5 - 5.8	4.9 - 6.2	5.4 - 6.9
			Ps (Pascals)	5	6	12	18	19	28	32
			NC	18	25	32	36	39	42	45

Series GD

Fixed Blade Swirl Diffusers



Description

For supply or extract air, unique fixed curved blade swirl diffuser offering excellent performance at low to medium air volumes. The rapid reduction in both air velocity and temperature differential lead to very comfortable conditions within the occupied zone. Suitable for ceiling or duct mounting.

Construction

From 0.8mm thick pressed sheet steel with 0.8 thick rear collar.

Size

Available in 595 x 595mm for lay-in ceiling tile replacer or 500 Ø neck size.

How to Specify

State Quantity, the series, product coding and the size width x height e.g 10 Qty. GDSF5SPF+4Y 595 x 595

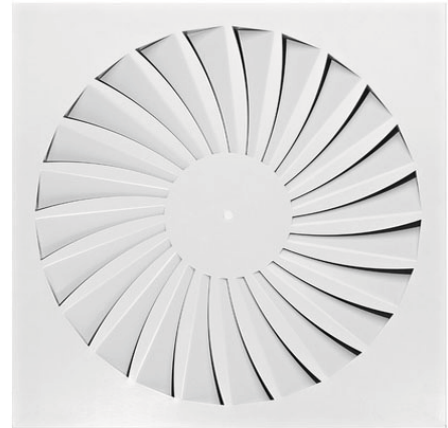

Series	Frame Style		Options		Options		Accessories		+	Fixings		Finish	
	Code	Description	Code	Description	Code	Description	Code	Description		Code	Description	Code	Description
GD	SF	Square Face Swirl	0	None	0	None	0	None		1	Neck Fixing	Y	PPC BS /RAL Colour
	CF	Circular Face Swirl	5	Plenum / Duct Fixing Bar	T	Top Inlet Plenum	PF	Perforated Flat Plate Damper		2	External Drop Rod Lugs		
					S	Side Inlet Plenum				3	Clip-in T-Bar		
										4	Lay-in Tile Replacer		

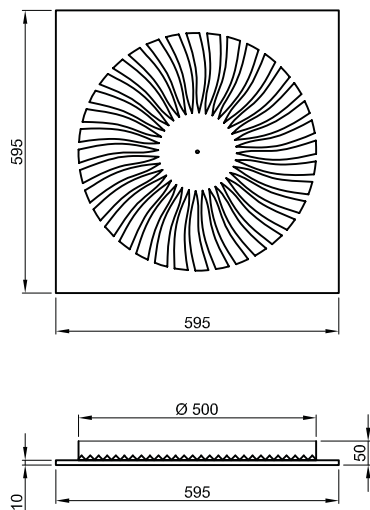

GDSF000

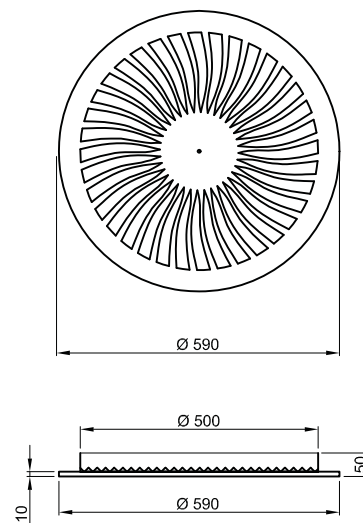

GDCF000

Series GD Fixed Blade Swirl Diffusers



SF - Square Face Swirl

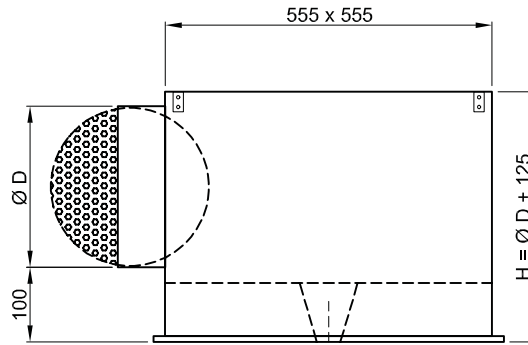
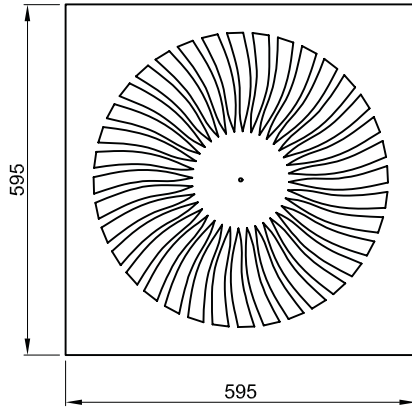

GDSF5SPF
'PF' Type damper optional

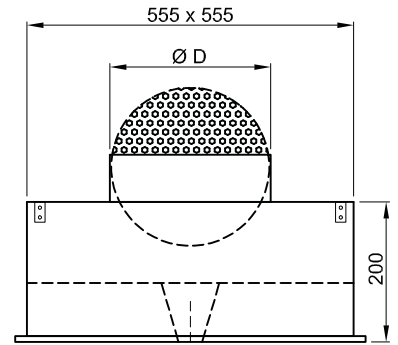

GDSF5TPF
'PF' Type damper optional

CF - Circular Face Swirl

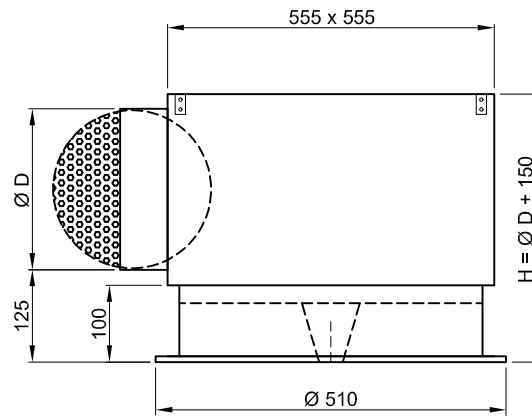
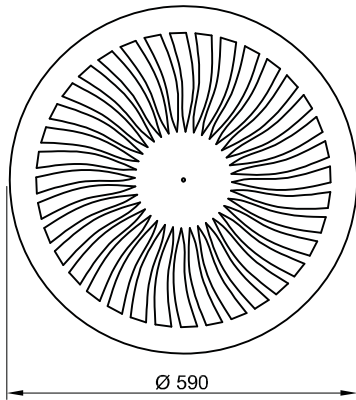

GDCF5SPF
'PF' Type damper optional

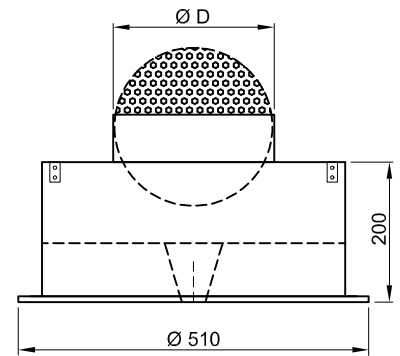

GDCF5TPF
'PF' Type damper optional

Series GFS Floor Swirl Diffuser



Description

Design for supply air applications, the floor swirl diffuser is suitable for installing into floors with a pressurized void, or can be ducted using an additional plenum box.

The diffuser includes an integral baffle, which can be adjusted to provide horizontal or vertical discharge patterns, along with a combined damper and dust basket.

Construction

The face plate and mounting ring are manufactured from cast aluminium, while the dust basket and baffle are formed from sheet mild steel.

The diffuser is supplied complete with fixing cleats to suit a floor Thickness up to 45mm.



Size

Available in size 200mm diameter only.

How to Specify

State Quantity, the series, product coding and the size width x height e.g **10 Qty. GFSDF200+C**

Series	Frame Style	Size	Options		+	Finish	
						Y	PPC /RAL Colour
GFS	DF	200	T	Top Inlet Plenum		C	Cast Aluminium
			S	Side Inlet Plenum			

Size	ØA	ØB	ØC	E
200	236	190	160	19

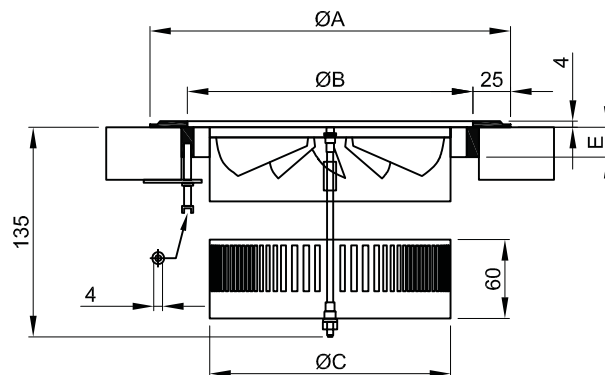
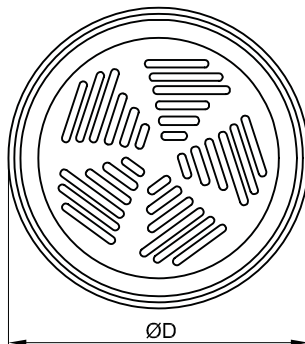

Series GFS Floor Swirl Diffuser



SELECTION DATA						
q (l/s)	14	16	20	25	30	40
Lt Horizontal (M)	0.5	0.6	0.7	0.9	1.1	1.4
Lt Vertical (M)	0.62	0.72	0.9	1.1	1.3	1.8
Ps (Pa)	13	16	26	40	60	105
NC Horizontal Throw	<15	15	22	26	32	45
NC Vertical Throw	<15	<15	15	20	25	33



Pressure drop figures given above are with the combined dust basket Damper set to the fully open position and with the diffuser set to a horizontal Throw pattern. Apply a correction factor of Ps x 0.9 vertical throw settings.

Damper adjustment will influence the pressure drop and noise figures. Apply the following correction factors:

Damper position 50% Open Ps X 1.4 + 2 NC
 25% Open Ps X 2.0 + 8 NC

Throw values given are at 0.5 M/s Vt and are valid for horizontal throws With a Td-10°C to 20°C. Vertical throws will reduce when used for cooling, In this case apply the following factors.

Td 0°	-4°	-6°	-8°	-10°
Lt X 1	Lt x 0.7	Lt x 0.6	Lt x 0.5	Lt x 0.45